

Информация

d1 = Диаметр стержня
d2 = Диаметр головки
d3 = Диаметр утолщения
K = Толщина головки
L1 = Длина
L2 = Длина утолщения + толщина головки
Стандарт: DIN1530/ISO8694
Материал: сталь WAS (~1.2344)
Макс. темп.: 500-550 °C
Шероховатость: Ra

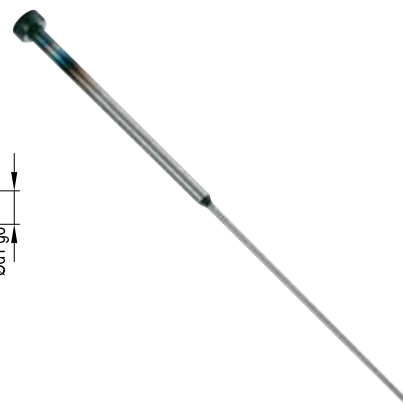
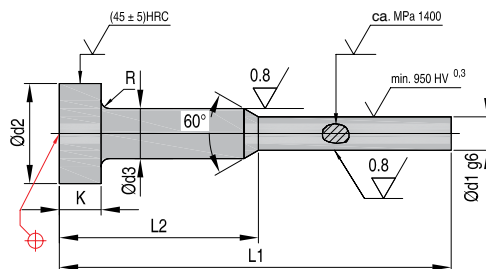

Код для заказа	Тип	d1 g6	d2 0 0,2	d3 h11	K 0 0,05	R +0,2 0	L 1 ⁺⁰ ₀									
							0080	0100	0125	0160	0160	0160	0200	0250	0250	
							L 2 ¹ ₂									
							0035	0050	0050	0050	0063	0075	0075	0075	0100	
EPС05 0-7 L1 L2	C	0,700	4,0	2,0	2,0	0,2										
EPС05 0-8 L1 L2		0,800	4,0	2,0	2,0	0,2										
EPС05 0-9 L1 L2		0,900	4,0	2,0	2,0	0,2										
EPС05 1-0 L1 L2		01,00	4,0	2,0	2,0	0,2										
EPС05 1-1 L1 L2		01,10	4,0	2,0	2,0	0,2										
EPС05 1-2 L1 L2		01,20	4,0	2,0	2,0	0,2										
EPС05 1-3 L1 L2		01,30	4,0	2,0	2,0	0,2										
EPС05 1-4 L1 L2		01,40	4,0	2,0	2,0	0,2										
EPС05 1-5 L1 L2		01,50	6,0	3,0	3,0	0,3										
EPС05 1-6 L1 L2		01,60	6,0	3,0	3,0	0,3										
EPС05 1-7 L1 L2		01,70	6,0	3,0	3,0	0,3										
EPС05 1-8 L1 L2		01,80	6,0	3,0	3,0	0,3										
EPС05 1-9 L1 L2		01,90	6,0	3,0	3,0	0,3										
EPС05 2-0 L1 L2		02,00	6,0	3,0	3,0	0,3										
EPС05 2-1 L1 L2		02,10	6,0	3,0	3,0	0,3										
EPС05 2-2 L1 L2		02,20	6,0	3,0	3,0	0,3										
EPС05 2-3 L1 L2		02,30	6,0	3,0	3,0	0,3										
EPС05 2-4 L1 L2		02,40	6,0	3,0	3,0	0,3										
EPС05 2-5 L1 L2		02,50	6,0	3,0	3,0	0,3										
EPС05 2-6 L1 L2		02,60	6,0	3,0	3,0	0,3										
EPС05 2-7 L1 L2		02,70	6,0	3,0	3,0	0,3										
EPС05 2-8 L1 L2		02,80	6,0	3,0	3,0	0,3										
EPС05 2-9 L1 L2		02,90	6,0	3,0	3,0	0,3										
EPС05 3-0 L1 L2		03,00	8,0	4,0	3,0	0,3										
EPС05 3-1 L1 L2		03,10	8,0	4,0	3,0	0,3										
EPС05 3-2 L1 L2		03,20	8,0	4,0	3,0	0,3										
EPС05 3-3 L1 L2		03,30	8,0	4,0	3,0	0,3										
EPС05 3-4 L1 L2		03,40	8,0	4,0	3,0	0,3										
EPС05 3-5 L1 L2		03,50	8,0	4,0	3,0	0,3										

*Для L1 0160 0250 добавьте (5), (6), (7) для L2