

## Info Air Valve

Air valves improved for fast running applications

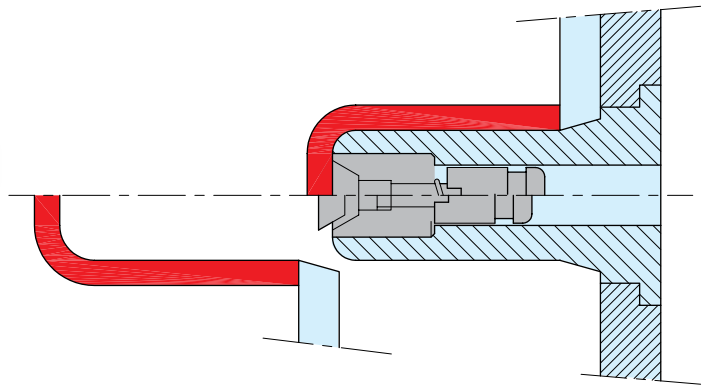

DME's team of experts has re-engineered the "long" type air valves resulting in increased strength and guaranteed reliability. Improvements to the internal design ensure strong, long-lasting function and flash-free shut-off. The same technology and know-how is applied to our new "short" type air valves ensuring high quality despite the economical price.

The "long" type air valves have been popular and successful for many years. they are used to remedy the vacuum problem often encountered when molding deep

or thin walled parts (flower pots, buckets, ...). At ejection, a blast of air opens the valve to break the vacuum and facilitate part ejection (see diagram).

DME now offers a range of valves suitable for all applications. Where space is limited the "short" type offers a compact solution. For more demanding applications, the "long" type offers excellent performance. Both types are of the highest quality and have been tested in extreme circumstances of temperature, pressure and cycle time.

## VA- i

Vacuum-/ Compressed air-valves "long" type Mat.: 1.4034 - 150°C - 3-10 bar

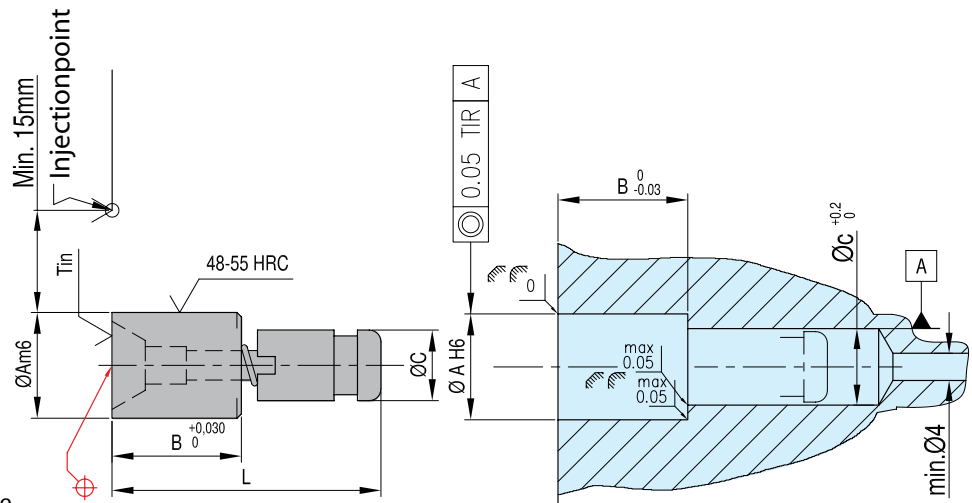

Tested on 2300 bar injection pressure

REF	A	B	C	L	c $\begin{smallmatrix} +0.2 \\ -0 \end{smallmatrix}$
VA-01 i	8	11	6	24,0	6,75
VA-02 i	12	18	8	34,0	9,00
VA-03 i	18	22	12	45,5	14,00

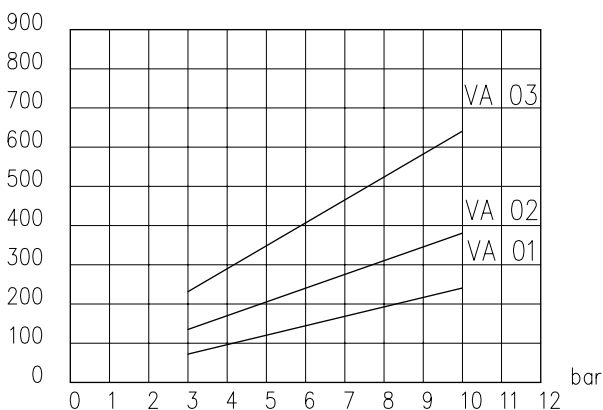

Vacuum-/ Compressed air-valves "short" type Mat.: 1.4034 - 150°C - 3-10 bar

VA

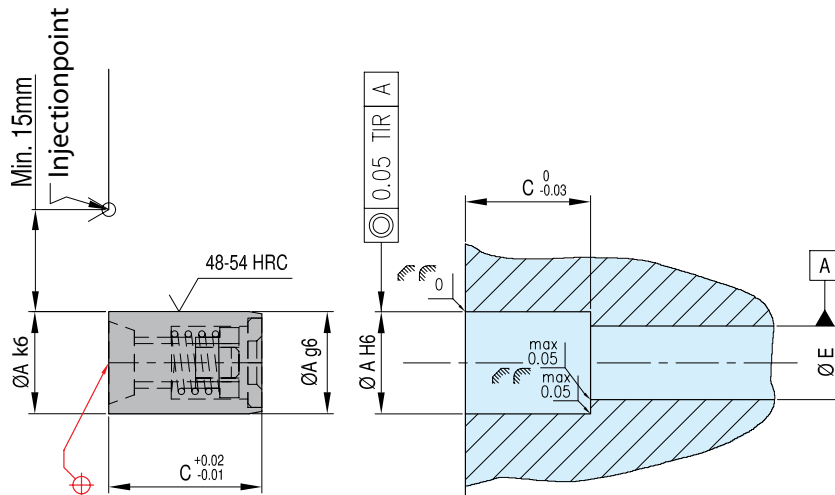

Tested on 2300 bar injection pressure

REF	A	C	E min
VA-08	8	12	4
VA-10	10	12	4
VA-12	12	12	4
VA-16	16	20	4
VA-20	20	20	4

Air-pins for Vacuum-/ Compressed air-valves

Mat.: WAS ~1.2344

LS

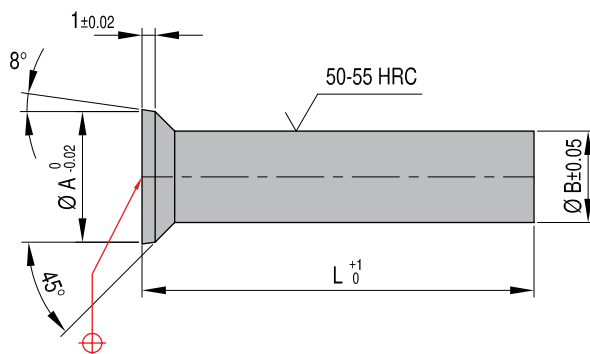

These pins avoid ejection problems due to a vacuum occurring in long, closed products. A blast of compressed air can be used in order to eject the moldings. Can be cut to required length and tapped for securing to ejector plates.

REF	L	A	B	C	Thread
LS-10	300	10	7	8	M5
LS-15	400	15	10	11	M6

Installation instructions

